

# PRAIRIE PROJECT DLE UNIT ON TRACK FOR DELIVERY

## HIGHLIGHTS

- The first commercial scale Direct Lithium Extraction (DLE) unit is currently being fabricated and on track to be complete in 2025.
- Phase 1 will see the Prairie Lithium Project go into production at Pad #1 using a commercial-scale DLE unit<sup>1</sup>. De-risking by a commercial-scale proof of concept allows production to be increased by rapid replication of the process equipment at Pad #1.
- Arizona Lithium has received approval for Phase 1 production at the Prairie Lithium Project from the Ministry of Energy and Resources in Saskatchewan.<sup>2</sup>

Arizona Lithium Limited (ASX: AZL, AZLO, OTC: AZLAF) (“Arizona Lithium”, “AZL” or “the Company”), a company focused on the sustainable development of the Prairie Lithium Project (“**Prairie**”), is pleased to provide an update on the fabrication of the Direct Lithium Extraction (“**DLE**”) equipment being provided by Koch Technology Solutions (“**KTS**”). The fabrication of the commercial scale KTS DLE unit is underway, with fabrication on track to be complete in 2025. The rendering in Figure 1 shows the design and size of the commercial scale KTS DLE unit. This design can be rapidly replicated and deployed to increase production on a modular basis across the project.

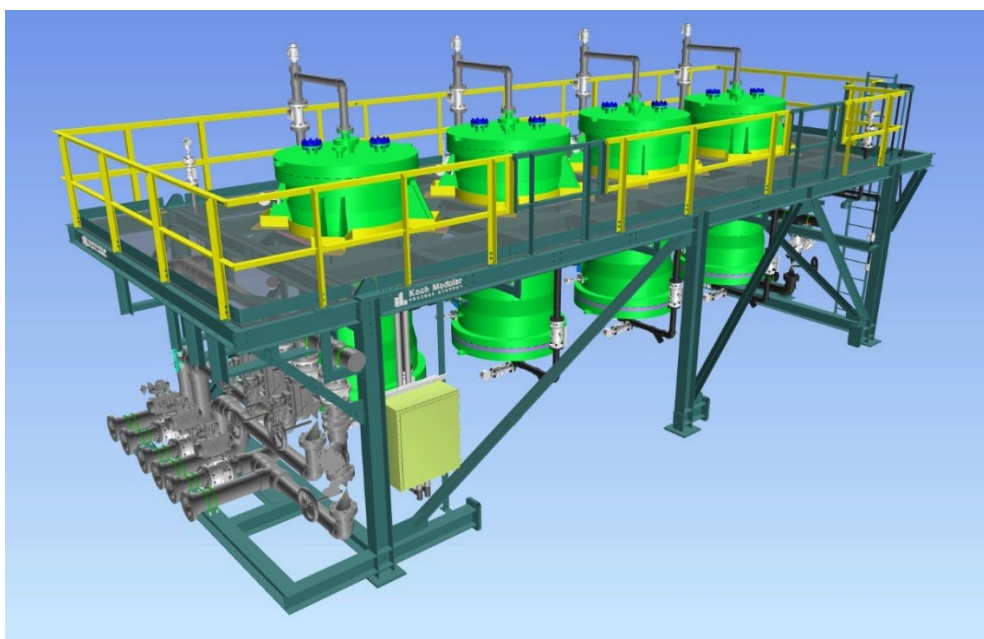

Figure 1: Rendering of KTS DLE LSS unit

<sup>1</sup> ASX Announcement – “North America’s First Lithium Brine Facility” – 17 February 2025

<sup>2</sup> ASX Announcement – “Prairie Project Production Approved & Project Update” – 23 May 2025

**Arizona Lithium Managing Director, Paul Lloyd, commented:** “DLE is the key to unlocking our massive resource at the *Prairie Lithium Project* in Saskatchewan, Canada. KTS has an incredible ability to execute major projects, and we are very pleased with the progress made to date on manufacturing the first commercial scale DLE unit. We see global lithium demand continuing to grow year over year, and more specifically, we see increased demand for our lithium that will be produced in Canada.”

### About the **Prairie Lithium Project**

AZL’s *Prairie Lithium Project* is located in the Williston Basin of Saskatchewan, Canada. Located in one of the world’s top mining friendly jurisdictions, the projects have easy access to key infrastructure including electricity, natural gas, fresh water, paved highways and railroads. The projects also aim to have strong environmental credentials, with Arizona Lithium targeting to use less use freshwater, land and waste, aligning with the Company’s sustainable approach to lithium development.



**Figure 2: Location of the *Prairie Lithium Project* in Saskatchewan, Canada**

This ASX announcement is authorised for release by the Board.

### **For further information please contact:**

Mr. Paul Lloyd  
Managing Director  
Tel. +61 419 945 395  
[paul@arizonalithium.com](mailto:paul@arizonalithium.com)