

ASX ANNOUNCEMENT 25 JUNE 2024

## NOVIQTECH INTEGRATES GOOGLE GEMINI AI FUNCTIONALITY INTO CARBON CENTRAL PLATFORM

### KEY HIGHLIGHTS

NoviqTech is thrilled to announce a significant enhancement to its flagship SaaS product, Carbon Central.

With the integration of advanced AI capabilities, the company is taking a monumental step forward in providing unparalleled support and efficiency to its users. The new AI-powered chatbot, driven by the cutting-edge Google Gemini, is designed to revolutionize the way users interact with Carbon Central, providing comprehensive assistance, reporting and streamlined processes.

### Key Updates

#### Streamlined Project Setup and Digital Twin Management

The Carbon Central chatbot is also designed to streamline the setup of projects and creation of digital twins. This intelligent assistant can perform various tasks significantly reducing the time and effort needed to manage each enterprise's projects.

In addition, combining the digital twin with the chat-box, will provide step-by-step guidance for mapping real-world processes into digital twins and facilitates integration with real meters and external data sources.

Finally, the chatbot will provide valuable insights from the projects digital twin database, enabling users to optimise their carbon asset management.

#### Token Creation and Trust Chain Insights

In addition to project setup and management, the chatbot assists in optimising carbon asset management through digital twin data.

It provides insights and suggestions for token creation, helping users calculate the costs

of tokenisation. Users can also gain more in-depth insights from the trust chain database, offering unlocked access to analyse the tokens they have created. The chatbot integration with trust chain reinforces the projects timeline of all events, ensuring auditability and transparency.

### Expert Guidance on Policies and Standards

The Carbon Central chatbot is designed to provide comprehensive information on policies and standards relevant to customer projects, including carbon management, credits, and renewable fuels such as hydrogen.

Whether seeking insights on compliance requirements or best practices, this new chatbot serves the enterprises primary resource for all policy-related inquiries.

In addition, the chatbot will offer companies with live tutorials and walkthroughs for various features of Carbon Central, integrating seamlessly with our extensive knowledge base. New users will find it especially helpful as the chatbot will guide them through the setup process, providing tips and FAQs, and existing users can leverage the most up-to-date information.

The integration of Google Gemini into Carbon Central is a testament to NoviqTech's commitment to innovation and excellence. By leveraging the powerful capabilities of Google Gemini AI, we aim to provide our users with the tools they need to succeed in the dynamic and evolving landscape of carbon management.

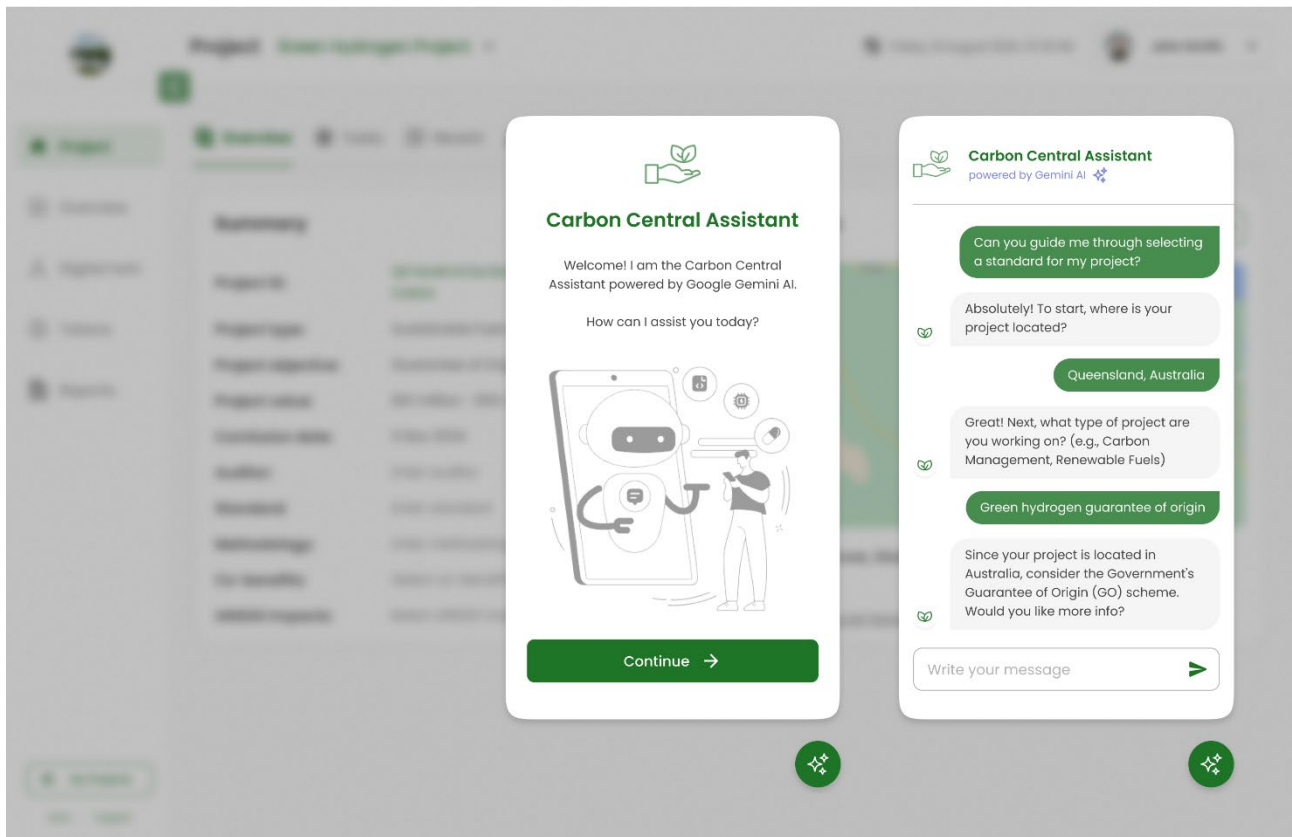

Authorised by the NoviqTech Board of Directors.

//End

For any queries relating to this announcement, please contact:

[Investors@noviqtech.com](mailto:Investors@noviqtech.com)

## About NoviqTech

NoviqTech (ASX: NVQ) harnesses the power of artificial intelligence and distributed ledger technology to provide trusted and transparent reporting across supply chains, carbon emissions reporting, and guarantee of origin. The NoviqTech brands – NoviqAI and TYMLEZ deliver novel and innovative technologies to organisations across the globe in sectors from maritime to regenerative agriculture, empowering them to make more informed decisions, track their carbon emissions with precision, and validate the authenticity of their products' origins all in real-time

Visit [noviqtech.com](https://noviqtech.com) for more information.